

Axis

AXIS office environments create a sense of community & space and support dynamic changes in workplace technologies while evolving work practices.



AXIS STRAIGHTLINE



Axis Straightline with Ignite Screens, Axis Caddies with BBF & Tambour Inserts, transom mount shelves.

STANDARD FEATURES

- 2.0" x 2.0" end frames with flush ground weld finish
- 2.0" x 1.0" rails
- 3.0" height adjustment in each foot
- White worksurfaces are in stock. Other finish options are available
- Silver powdercoat and Arctic White powdercoat to all steel components.

STANDARD WORKTOP SIZES STRAIGHTLINE

- 48"w x 24"d x 28.75"h
- 48"w x 30"d x 28.75"h
- 60"w x 24"d x 28.75"h
- 60"w x 30"d x 28.75"h
- 72"w x 24"d x 28.75"h
- 72"w x 30"d x 28.75"h



Straightline Desk



Straightline Two Sided



Straightline Single Sided Double



Straightline Two Sided Double



Straightline Single Sided Triple



Straightline Two Sided Triple

AXIS SYSTEM SIZE GUIDE

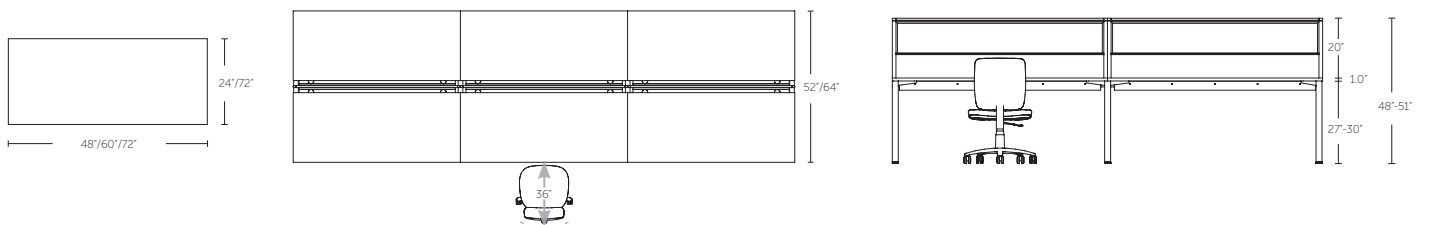

AXIS 90°



Axis Desking with Ignite Screens, Balance Seating, Axis Mobiles and Shelves

STANDARD FEATURES

- 2.0" x 2.0" end frames with flush ground weld finish
- 2.0" x 1.0" rails
- 3.0" height adjustment in each foot
- White worksurfaces are in stock. Other finish options are available
- Silver powdercoat and Arctic White powdercoat to all steel components.



90 Degree Workstation



90 Degree Two Pod



90 Degree Four Pod



90 Degree Eight Cluster

STANDARD WORKTOP SIZES 90° DEGREE

72" x 72"w x 24"d x 28.75"h

72" x 72"w x 30"d x 28.75"h

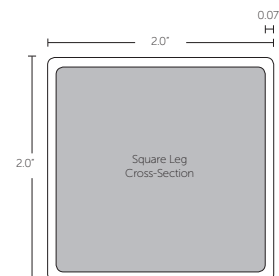
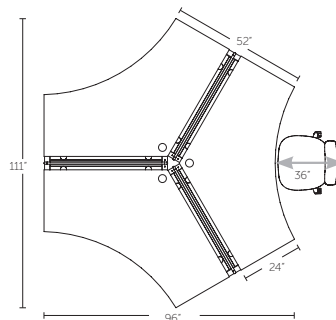
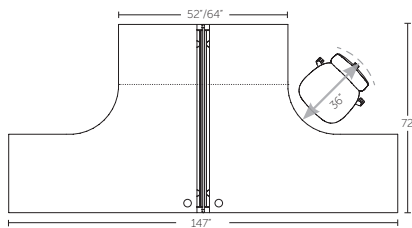
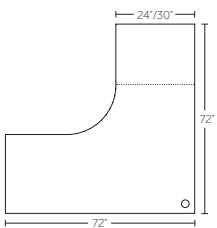

AXIS 120°



Axis Desking with Ignite Screens

STANDARD FEATURES

- 2.0" x 2.0" end frames with flush ground weld finish
- 2.0" x 1.0" rails
- 3.0" height adjustment in each foot
- White worksurfaces are in stock. Other finish options are available
- Silver powdercoat and Arctic White powdercoat to all steel components.

STANDARD WORKTOP SIZES 120° DEGREE

48" x 48"w x 24"d x 28.75"h



120 Degree Workstation



120 Degree 2/3



120 Degree Three Cluster



120 Degree Six Cluster

TORONTO + 416 441 9898

WORKSPACE 



ANVIL



AXIS



AGILE



STORAGE
& RECEPTION



MODULUS



MODULUS
FLIP



UNI FLIP